

Rigid Suction Lances RSL and Foot Valves FV

Installation and operating instructions



Original installation and operating instructions.

CONTENTS

	Page
1. Safety instructions	3
1.1 Symbols used in this document	3
1.2 Qualification and training of personnel	3
1.3 Safe operation	3
1.4 Safety instructions for the operating company/operator	3
2. Product introduction	3
2.1 Applications	3
2.2 Improper operating methods	3
2.3 Function	3
2.4 Warranty	4
2.5 Product description	4
2.6 Identification	5
3. Technical data	6
3.1 Dimensions	7
4. Installation	8
4.1 Hydraulic connection	8
4.2 Electrical connection of level indication	9
4.3 Container connection	10
5. Maintenance and service	12
5.1 Maintenance	12
5.2 Service	12
6. Fault finding	13
7. Disposal	13



Warning

Prior to installation, read these installation and operating instructions. Installation and operation must comply with local regulations and accepted codes of good practice.

1. Safety instructions

1.1 Symbols used in this document

The safety instructions are identified by the following symbols:



Warning

If these safety instructions are not observed, it may result in personal injury.



If these safety instructions are not observed, it may result in malfunction or damage to the equipment.

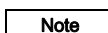

Notes or instructions that make the job easier and ensure safe operation.

1.2 Qualification and training of personnel

The personnel responsible for the installation, operation and service must be appropriately qualified for these tasks.

Areas of responsibility, levels of authority and the supervision of the personnel must be precisely defined by the operator.

If necessary, the personnel must be trained appropriately.

1.3 Safe operation

If safe operation is no longer possible, the product must be taken out of operation and secured against unintentional operation.

This is the case in the following situations:

- If the product is visibly damaged.
- If the product no longer seems operational.
- After long periods of storage under unfavourable conditions.

1.4 Safety instructions for the operating company/operator

The owner of the system is responsible for training of operating personnel.



Warning

When working with chemicals, the accident prevention regulations applicable at the installation site must be applied.

Observe the chemical manufacturer's safety data sheets when handling chemicals.



Warning

When working on the product, or connections and lines, always wear protective clothing (e.g. safety goggles and gloves).

The system must be unpressurised.

Only operate the system if all lines are connected correctly.



Warning

The chemical resistance of the parts that come into contact with the dosing medium depends on the medium, media temperature and operating pressure.

Ensure that all parts in contact with the medium are resistant to the medium under operating conditions.

2. Product introduction

2.1 Applications

The foot valve and the rigid suction lance are suitable for the following applications:

- Extraction of chemicals from unpressurised containers.
- Monitoring the liquid level in the chemical container (versions with two-step level indication).

Special features:

- Protection of the suction assembly (suction lance).
- Easy handling when exchanging containers.

2.2 Improper operating methods



Warning

Improper use, foreseeable misuse or misapplication can lead to personal injury and damage to the equipment and is therefore not permitted.

The operational safety of the product is only guaranteed, if it is used in accordance with section 2.1 Applications.

The product may not be used for:

- operation in potentially explosive areas
- combustible media
- frozen media
- abrasive or crystallising media.

2.3 Function

- Extracting liquid from a container with a suction line.
- Filtering the liquid to protect the pump from soiling.
- Preventing backflow of liquid by means of a non-return valve.
- Keeping the foot valve upright at the container bottom.
- Indicating a low level of liquid or an empty tank by means of two reed switches and floaters.
- Connecting an exchangeable container.

2.4 Warranty

A warranty claim in accordance with our general terms of sale and delivery is only valid if these requirements are fulfilled:

- The product is used in accordance with the information within this manual.
- The product is not dismantled or handled incorrectly.
- Maintenance is carried out by authorised and qualified personnel.
- Only original spare parts are used for repairs during maintenance.

Note

Grundfos cannot be held liable for any damage resulting from incorrect use.

2.5 Product description

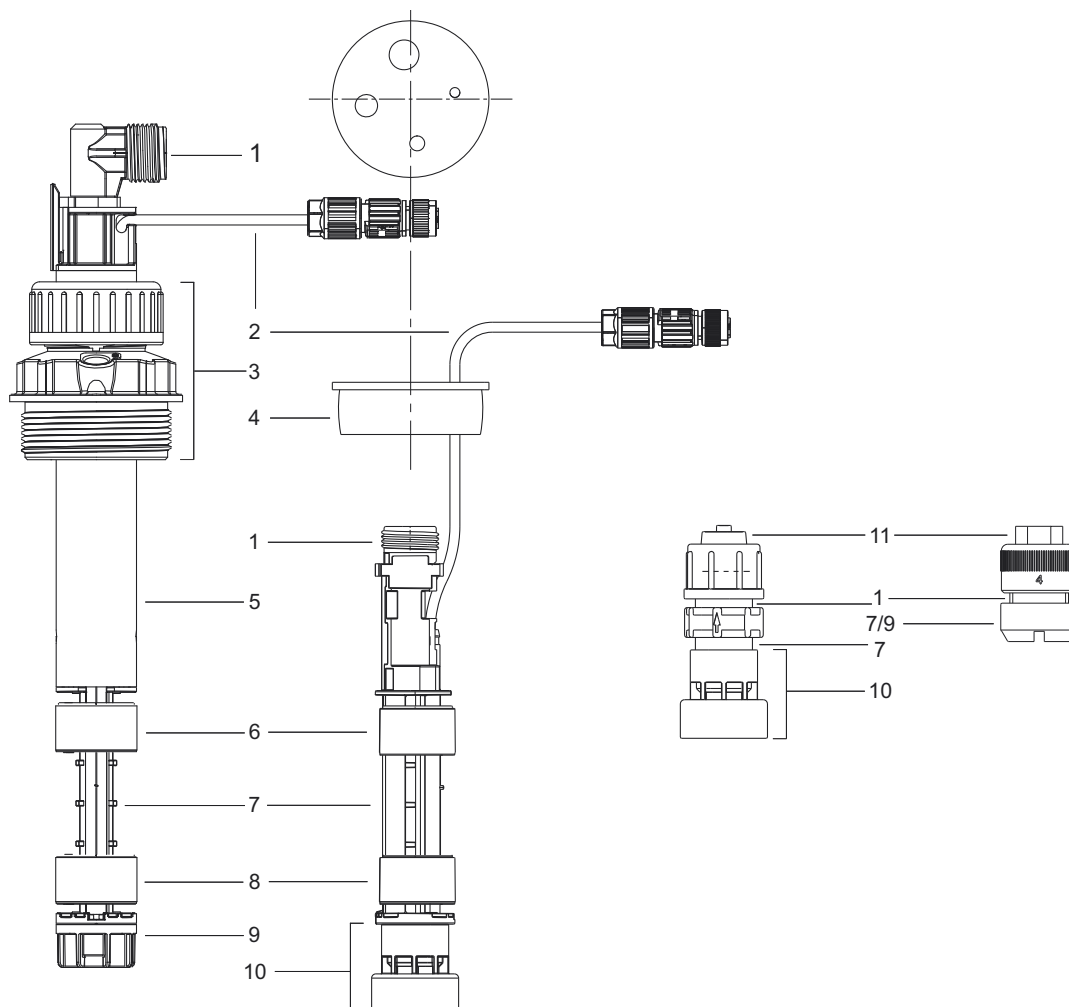

Fig. 1 From left to right: suction lance, foot valve with level indication, plastic and stainless-steel foot valve without level indication

Pos.	Description
1	Hose connection thread
2	Signal cable with plug
3	Tank connection, slidable
4	Tank cap, slidable
5	Protective tube with hose
6	Floater low-level
7	Valve body with switch unit
8	Floater empty
9	Inlet with strainer
10	Inlet with strainer and weight
11	Connection for hose or pipe

2.6 Identification

2.6.1 Type key of suction lances

Code	Example	RSL	-	0500	-	2L	-	G5/8	PE	/	V,E	/	C	U2
RSL	Rigid Suction Lance													
	Maximum immersion depth													
0400	up to 400 mm													
0500	up to 500 mm													
0570	up to 570 mm													
0690	up to 690 mm													
0820	up to 820 mm													
0980	up to 980 mm													
1100	up to 1100 mm													
1200	up to 1200 mm													
	Level indication													
NL	Without level indication													
2L	Two-step level indication (low-level signal, tank-empty signal)													
	Connection size													
G5/8	Male thread G 5/8 with groove for O-Ring on top													
	Material of enclosure, connection, floater													
PE	High density polyethylene (HDPE)													
PV	Polyvinylidenfluoride (PVDF)													
	Material of O-ring													
V,E	Fluorocarbon elastomer (FKM) and ethylene propylene diene rubber (EPDM)													
T	Polytetrafluorethylene (PTFE)													
	Material of ball													
C	Ceramic													
	Connections for hose													
U2	Hose connection set: 4/6 mm, 6/9 mm, 6/12 mm, 9/12 mm													
U7	Hose connection set: 0.17" x 1/4", 1/4" x 3/8", 3/8" x 1/2"													
X	Without connections													

2.6.2 Type key of foot valves

Code	Example	FV	-	2L	-	G5/8	PE	/	V,E	/	C	U2
FV	Foot valve											
	Level indication											
NL	Without level indication											
2L	Two-step level indication (low-level signal, tank-empty signal)											
	Connection size											
G5/8	Male thread G 5/8 with groove for O-Ring on top											
	Material of enclosure, connection, floater											
PE	High density polyethylene (HDPE)											
PV	Polyvinylidenfluoride (PVDF)											
SS	Stainless steel 1.4571											
	Material of O-ring											
V,E	Fluorocarbon elastomer (FKM) and ethylene propylene diene rubber (EPDM)											
T	Polytetrafluorethylene (PTFE)											
	Material of ball											
C	Ceramic											
SS	Stainless steel 1.4401											
	Connections for hose or pipe											
U2	Hose connection set: 4/6 mm, 6/9 mm, 6/12 mm, 9/12 mm											
U7	Hose connection set: 0.17" x 1/4", 1/4" x 3/8", 3/8" x 1/2"											
A	Threaded pipe connection Rp 1/4" (G 1/4" female)											
V	Threaded pipe connection 1/4" (NPT female)											
X	Without connections											

3. Technical data

Data		Foot valve and suction lance (PE)	Foot valve and suction lance (PVDF)	Foot valve (stainless steel)	
Mechanical data	Max. flow rate ¹⁾	[l/h]	60		
		[gph]	15.85		
	Max. pressure ²⁾	[bar]	2		
		[psi]	29		
	Max. liquid temperature	[°C]	45	60	80
	Min. liquid temperature	[°C]	0	0	-10
	Max. ambient temperature	[°C]	45		
	Min. ambient temperature	[°C]	0	0	-10
	Max. storage temperature	[°C]	45		
	Min. storage temperature	[°C]	0	0	-10
Electrical data (for versions with two-step level indication)	Length of included signal cable ³⁾	[m]	5	5	-
	Type of included signal cable		LIY2Y	LIY2Y	-
	Max. voltage of reed switches	[V]	48	48	-
	Max. current of reed switches	[A]	0.5	0.5	-
Weight ⁴⁾	Suction lance	[kg]	0.28 - 0.4	0.43 - 0.62	-
	Foot valve without level indication	[kg]	0.11	0.13	0.18
	Foot valve with level indication	[kg]	0.26	0.28	-

1) Liquids with viscosity similar to water

2) Applies to the inside of the suction installation. The container must be unpressurised!

3) Also for suction lances, the indicated cable length is measured starting from the valve body

4) When installed, without packaging

3.1 Dimensions

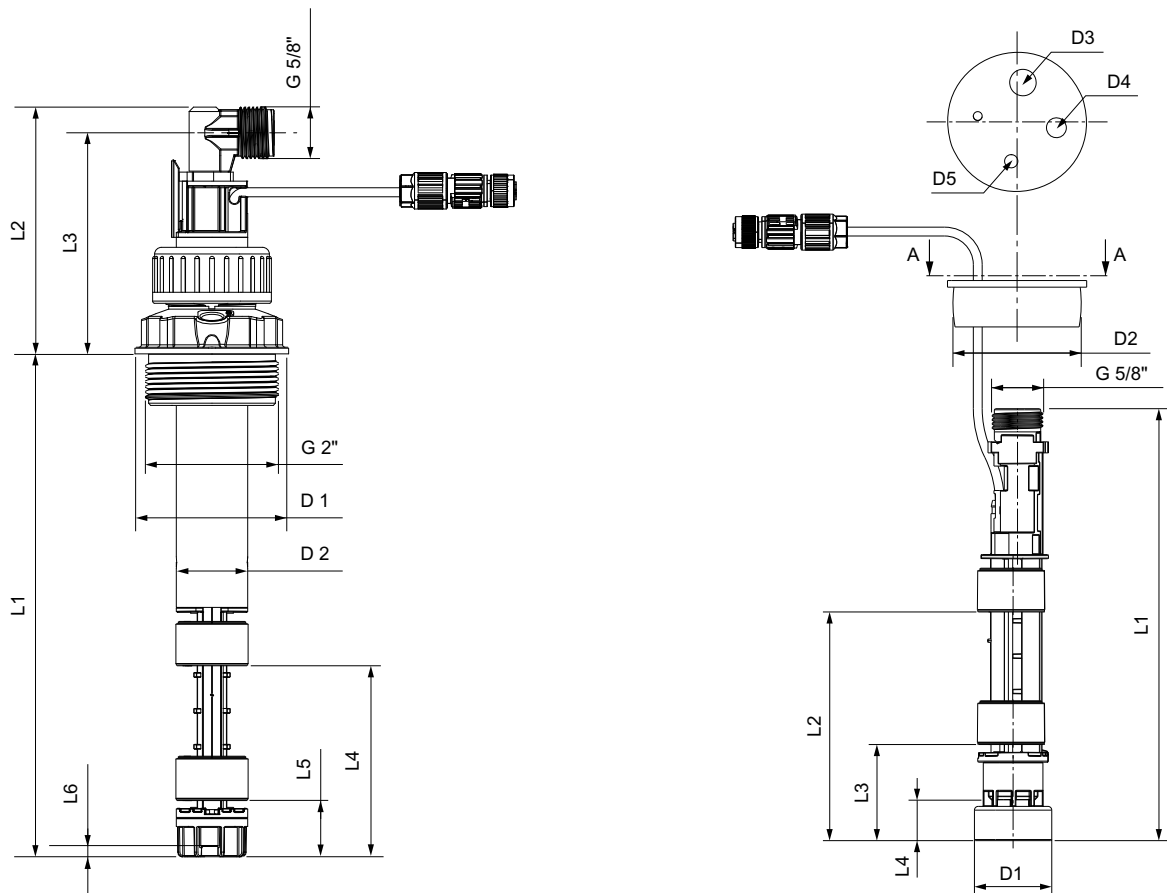

Fig. 2 Left: rigid suction lance with / without level indication, right: foot valve with level indication

Code	Dimensions [mm]	
	Suction lance	Foot valve
L1	see type key 2.6.1	196
L2	≥ 114	~ 103.5
L3	≥ 103	~ 43.5
L4	~ 85	18.5
L5	~ 25	-
L6	4.5	-
D1	68.5	35
D2	32	58
D3	-	12
D4	-	9
D5	-	6

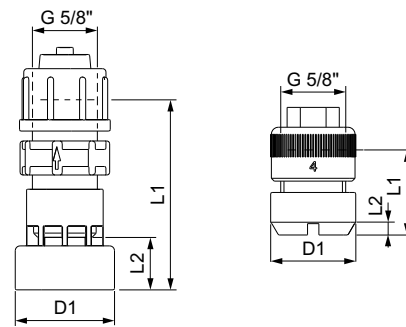

Fig. 3 Foot valve without level indication. Left: PE and PVDF version, right: stainless-steel version

Code	Dimensions [mm]	
	Foot valve PE, PVDF	Foot valve stainless steel
L1	67.5	30
L2	19	4
D1	35	30

TM04 8445 4511, TM04 8447 4511

TM04 8446 4511, TM04 8494 0612

4. Installation

4.1 Hydraulic connection



Warning

Danger of chemical burn!

Avoid direct contact with chemicals.

Wear protective clothing when handling chemicals.

4.1.1 Conditions for installation

- Proper functioning can only be guaranteed when using Grundfos accessories.
- For suction height and line diameter, please see the technical data of the pump.

4.1.2 Notes for installation

- Shorten the hoses at right angles.
- Make sure there are no loops or kinks in the hoses.
- Keep the suction line as short as possible.
- Install the suction line upwards to the suction valve of the pump.

4.1.3 Connecting the hose (fig. 4)

1. Slide union nut (2) and tensioning ring (3) onto the hose (1).
2. Insert the cone part (4) fully into the hose.
3. Put the cone part with hose onto the corresponding threaded connection of foot valve / suction lance or suction valve of the pump.
4. Tighten union nut manually. Do not use any tools!
 - Tighten up union nut after 2-5 operating hours if using PTFE gaskets!
5. If existing, insert the deaeration line of the pump and the relief line of the multi-function or pressure relief valve via the corresponding connection of the foot valve or suction lance into the container.

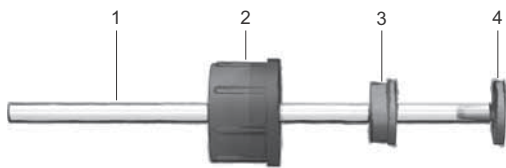

TM04 8559 2212

Fig. 4 Hydraulic connection

Pos.	Description
1	Hose
2	Union nut
3	Tensioning ring
4	Cone part



Warning

Do not immerse the return lines into the liquid.

4.2 Electrical connection of level indication

In order to monitor the filling level of the container, a two-step level indication (low-level signal, tank-empty signal) can be connected to the pump or other downstream devices.

Note Observe the manuals of the downstream devices.

4.2.1 Signal connection with round plug

All SMART Digital pumps and the digital dosing pump DDI 222 are connected with round plugs.

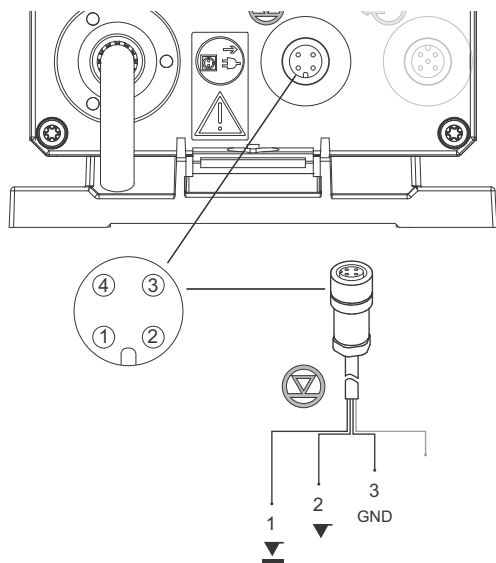

TM04 8448 4511

Fig. 5 Signal connection with round plug

Level signal: low-level and tank-empty

Function	Pins		
	1/white	2/green	3/brown
Low level	X		GND
Tank empty		X	GND

4.2.2 Signal connection with flat plug

The foot valves and suction lances are supplied with round plugs. An adapter is required for connection to the dosing pumps DMX 221 and DMH with AR control.

Product number: 96635010

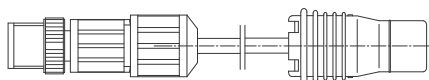

TM04 8449 4511

Fig. 6 Flat plug

4.2.3 Changing the contact type

Suction lances and foot valves with two-step level indication have two signal outputs. Both are factory-set to NO contact type. The symbol is on the floater top (see fig. 7).

- The symbol that is visible from above shows the switch mode "floater above".
- The symbol that is visible from below shows the switch mode "floater below".

The contact type can be changed from NO to NC by turning the floater horizontally by 180°. A cable break will provoke a tank-empty signal.

Reversing the floater:

1. Remove the floater sideways
2. Turn the floater horizontally by 180° and attach it. Make sure that the NC symbol at the floater points upwards.
3. Adjust the signal inputs of the downstream devices (pump) accordingly

Note Observe the manuals of the downstream devices (pump).

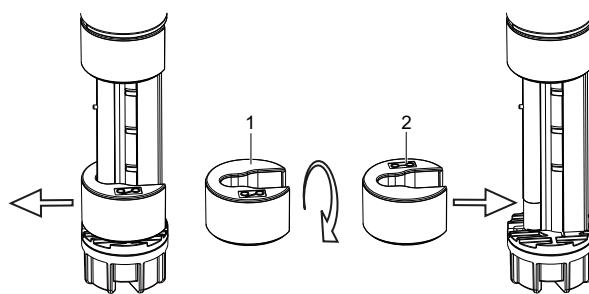

TM04 8451 1112

Fig. 7 Changing the contact type

Pos.	Description	Symbol
1	Floater NO (normally open) contact	
2	Floater NC (normally closed) contact	

4.3 Container connection

4.3.1 Connecting to a Grundfos tank

1. Remove the screw cap from the tank.
2. Insert suction lance / foot valve into the threaded hole of the tank. Tighten the adapter screw manually.
3. Adapt the immersion depth of suction lance / foot valve to the tank height.



Fig. 8 Inserting the suction lance



Fig. 9 Inserting the foot valve

4. Fasten suction lance at hose connection.



Fig. 10 Fastening the suction lance

5. Fasten return lines, if existing.

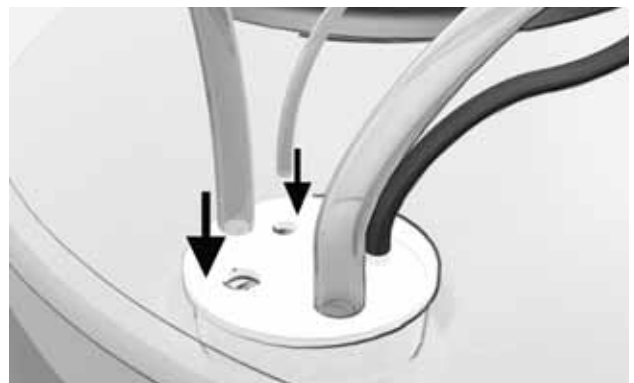

Fig. 11 Foot valve: insert lines into PE cap



Fig. 12 Suction lance: insert lines into tank connection



Warning

Do not immerse the return lines into the liquid.

TM04 8511 1012

TM04 8513 1012

TM04 8514 1012

TM04 8515 1012

TM04 8512 1012

4.3.2 Connecting to an exchangeable container

1. Select adapter type and immersion depth from the tables below.
2. Mount adapter on foot valve or suction lance.
3. Adapt immersion depth of foot valve or suction lance (see table).

Immersion depth of suction lances

Container type	Volume [l]	Immersion depth [mm]
L-ring drum (blue)	120	820
	220	980
Steel drum (standard)	216	980
Standard jerrican according to EN 12712/12713	12, 33 (large opening)	400
	25, 30, 33	500
	60	690
IBC (intermediate bulk container)	all	1200

Adaptors for exchangeable containers

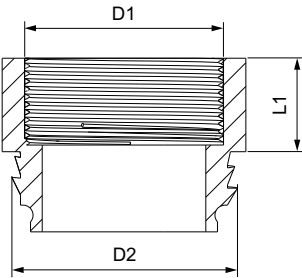
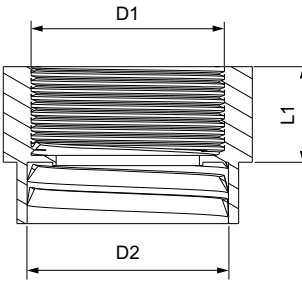
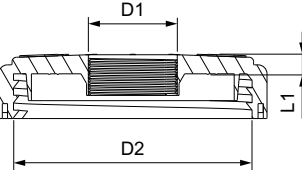
Dimensioned drawing	Dimensions			Adaptor type	Material, colour	Product No.	
	D1	D2	L1				
	G 2	2 NPT	31 mm	Adaptor for containers with 2" NPT threaded opening	PVC, grey	98156690	
	TM04 8490 0612	G 2	S 70 x 6	28 mm	Adaptor for drums with S 70 x 6 coarse thread (MAUSER 2")	PE, blue	98071171
		G 2	S 56 x 4	28 mm	Adaptor for drums with S 56 x 4 coarse thread (TriSure®)	PE, orange	98071172
	G 2	CCS 46 x 4	28 mm	Adaptor for jerricans with opening of approx. 36 mm, according to EN 12713	PE, green	98071173	
	TM04 8491 0612	G 2	CCS 60 x 6	28 mm	Adaptor for jerricans with opening of approx. 45 mm, according to EN 12713	PE, yellow	98071174
		G 2	CCS 70 x 6	31 mm	Adaptor for jerricans with opening of approx. 57 mm, according to EN 12713	PE, brown	98071175
		G 2	ASTM 63	28 mm	Adaptor for US containers with bung hole of 63 mm (ASTM International)	PE, white	98071176
	TM04 8493 0612	G 2	S 160 x 7	12.8 mm	Adaptor for IBC (Intermediate Bulk Container) with opening of 150 mm	PE, black	98071177

4.3.3 Connecting a suction lance to a container without opening provided

4. Cut a hole (Ø60) into the container top surface and insert the suction lance.
5. Fix the suction lance with the counter nut.
6. Adapt the immersion depth of the suction lance (see section 4.3.1).

Immersion depth of suction lances

Container type	Volume [l]	Immersion depth [mm]
Grundfos cylindrical tank	40	400
	1000	1200
Grundfos square tank	100	470

When using other containers, the required immersion depth must be determined by measurement.

Counter nut

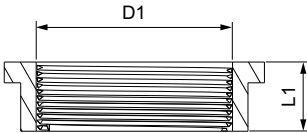
Dimensioned drawing	Dimensions		Adaptor type	Material, colour	Product No.
	D1	L1			
	G 2	21 mm	Counter nut for drums with opening of 60 mm (without thread), e.g. 100-litre square tank or 1000-litre cylindrical tank	PVC, grey	98071170

5. Maintenance and service

Caution *Clean the strainer of the foot valve or suction lance regularly, depending on the degree of pollution.*

5.1 Maintenance

Clean the strainer,

- if it is soiled
- if the suction performance drops.

5.1.1 Cleaning the strainer

1. Shut down the dosing system.
2. Suction lances or foot valves with level indication: disconnect signal line from the pump or downstream device.
3. Remove suction line from the dosing head. If existing, remove deaeration line from the dosing head.
4. Take suction lance or foot valve out of the container.
5. Empty the suction lance.
6. Suction lance: Unscrew inlet with strainer unit from the bottom of the suction lance and clean it.
Foot valve: Unscrew inlet with weight and strainer from the valve, remove the strainer and clean it.

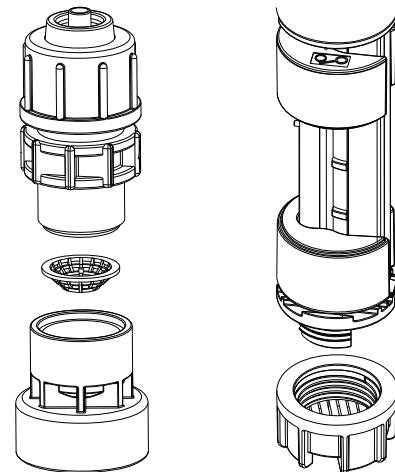

Fig. 13 Foot valve (left), suction lance (right): removing the strainer

5.2 Service

Foot valves and suction lances cannot be repaired.

6. Fault finding

Fault	Possible cause	Possible remedy
Too low flow or no flow	Strainer is soiled.	Clean the strainer.
	Pump is switched off.	Switch on the pump.
	Suction line is installed incorrectly.	Check the suction line and connection.
	Internal diameter of suction line is too small.	Use suction line with larger internal diameter.
	Suction line is not tight.	Check the line and connections.
Low-level or empty indication does not work	Signal line is not connected to the pump.	Connect the signal line to the pump.
	Contact type is set incorrectly.	Adapt setting of contact type (see section 4.2.3).
	Reed switch is defective.	Replace the foot valve or suction lance.

7. Disposal

This product or parts of it must be disposed of in an environmentally sound way. Use appropriate waste collection services. If this is not possible, contact the nearest Grundfos company or service workshop.

Subject to alterations.

Argentina

Bombas GRUNDFOS de Argentina S.A.
Ruta Panamericana km. 37.500 Lote 34A
1619 - Garin
Pcia. de Buenos Aires
Phone: +54-3327 414 444
Telefax: +54-3327 411 111

Australia

GRUNDFOS Pumps Pty. Ltd.
P.O. Box 2040
Regency Park
South Australia 5942
Phone: +61-8-8461-4611
Telefax: +61-8-8340 0155

Austria

GRUNDFOS Pumpen Vertrieb Ges.m.b.H.
Grundfosstraße 2
A-5082 Grödig/Salzburg
Tel.: +43-6246-883-0
Telefax: +43-6246-883-30

Belgium

N.V. GRUNDFOS Bellux S.A.
Boomssesteenweg 81-83
B-2630 Aartselaar
Tél.: +32-3-870 7300
Télécopie: +32-3-870 7301

Belarus

Представительство ГРУНДФОС в
Минске
220123, Минск,
ул. В. Хоружей, 22, оф. 1105
Тел.: +(375) 17 233 97 65
Факс: (375) 17 233 97 69
E-mail: grundfos_minsk@mail.ru

Bosnia/Herzegovina

GRUNDFOS Sarajevo
Trg Heroja 16,
BiH-71000 Sarajevo
Phone: +387 33 713 290
Telefax: +387 33 659 079
e-mail: grundfos@bih.net.ba

Brazil

BOMBAS GRUNDFOS DO BRASIL
Av. Humberto de Alencar Castelo Branco,
630
CEP 09850 - 300
São Bernardo do Campo - SP
Phone: +55-11 4393 5533
Telefax: +55-11 4343 5015

Bulgaria

Grundfos Bulgaria EOOD
Slatina District
Iztochna Tangenta street no. 100
BG - 1592 Sofia
Tel. +359 2 49 22 200
Fax. +359 2 49 22 201
email: bulgaria@grundfos.bg

Canada

GRUNDFOS Canada Inc.
2941 Brighton Road
Oakville, Ontario
L6H 6C9
Phone: +1-905 829 9533
Telefax: +1-905 829 9512

China

**Grundfos Alldos
Dosing & Disinfection**
ALLDOS (Shanghai) Water Technology
Co. Ltd.
West Unit, 1 Floor, No. 2 Building (T 4-2)
278 Jinhua Road, Jin Qiao Export Process-
ing Zone
Pudong New Area
Shanghai, 201206
Phone: +86 21 5055 1012
Telefax: +86 21 5032 0596
E-mail: grundfosalldos-CN@grundfos.com

China

GRUNDFOS Pumps (Shanghai) Co. Ltd.
50/F Maxdo Centre No. 8 Xing Yi Rd.
Hongqiao Development Zone
Shanghai 200336
PRC
Phone: +86-21 6122 5222
Telefax: +86-21 6122 5333

Croatia

GRUNDFOS CROATIA d.o.o.
Cebini 37, Buzin
HR-10010 Zagreb
Phone: +385 1 6595 400
Telefax: +385 1 6595 499
www.grundfos.hr

Czech Republic

GRUNDFOS s.r.o.
Čapkovského 21
779 00 Olomouc
Phone: +420-585-716 111
Telefax: +420-585-716 299

Denmark

GRUNDFOS DK A/S
Martin Bachs Vej 3
DK-8850 Bjerringbro
Tlf.: +45-87 50 50 50
Telefax: +45-87 50 51 51
E-mail: info_GDK@grundfos.com
www.grundfos.com/DK

Estonia

GRUNDFOS Pumps Eesti OÜ
Peterburi tee 92G
11415 Tallinn
Tel: + 372 606 1690
Fax: + 372 606 1691

Finland

OY GRUNDFOS Pumpat AB
Mestarintie 11
FIN-01730 Vantaa
Phone: +358-3066 5650
Telefax: +358-3066 56550

France

Pompes GRUNDFOS Distribution S.A.
Parc d'Activités de Chesnes
57, rue de Malacombe
F-38290 St. Quentin Fallavier (Lyon)
Tél.: +33-4 74 82 15 15
Télécopie: +33-4 74 94 10 51

Germany

GRUNDFOS Water Treatment GmbH
Reetzstraße 85
D-76327 Pfinztal (Söllingen)
Tel.: +49 7240 61-0
Telefax: +49 7240 61-177
E-mail: gwt@grundfos.com

Germany

GRUNDFOS GMBH
Schlüterstr. 33
40699 Erkrath
Tel.: +49-(0) 211 929 69-0
Telefax: +49-(0) 211 929 69-3799
E-mail: infoservice@grundfos.de
Service in Deutschland:
E-mail: kundendienst@grundfos.de

Greece

GRUNDFOS Hellas A.E.B.E.
20th km. Athinon-Markopoulou Av.
P.O. Box 71
GR-19002 Peania
Phone: +0030-210-66 83 400
Telefax: +0030-210-66 46 273

Hong Kong

GRUNDFOS Pumps (Hong Kong) Ltd.
Unit 1, Ground floor
Siu Wai Industrial Centre
29-33 Wing Hong Street &
68 King Lam Street, Cheung Sha Wan
Kowloon
Phone: +852-27861706 / 27861741
Telefax: +852-27858664

Hungary

GRUNDFOS Hungária Kft.
Park u. 8
H-2045 Törökbálint,
Phone: +36-23 511 110
Telefax: +36-23 511 111

India

GRUNDFOS Pumps India Private Limited
118 Old Mahabalipuram Road
Thoraiakkam
Chennai 600 097
Phone: +91-44 4596 6800

Indonesia

PT GRUNDFOS Pompa
Jl. Rawa Sumur III, Blok III / CC-1
Kawasan Industri, Pulogadung
Jakarta 13930
Phone: +62-21-460 6909
Telefax: +62-21-460 6910 / 460 6901

Ireland

GRUNDFOS (Ireland) Ltd.
Unit A, Merrywell Business Park
Ballymount Road Lower
Dublin 12
Phone: +353-1-4089 800
Telefax: +353-1-4089 830

Italy

GRUNDFOS Pompe Italia S.r.l.
Via Gran Sasso 4
I-20060 Truccazzano (Milano)
Tel.: +39-02-95838112
Telefax: +39-02-95309290 / 95838461

Japan

GRUNDFOS Pumps K.K.
Gotanda Metalion Bldg. 5F,
5-21-15, Higashi-gotanda
Shiagawa-ku, Tokyo,
141-0022 Japan
Phone: +81 35 448 1391
Telefax: +81 35 448 9619

Korea

GRUNDFOS Pumps Korea Ltd.
6th Floor, Aju Building 679-5
Yeoksam-dong, Kangnam-ku, 135-916
Seoul, Korea
Phone: +82-2-5317 600
Telefax: +82-2-5633 725

Latvia

SIA GRUNDFOS Pumps Latvia
Deglava biznesa centrs
Augusta Deglava ielā 60, LV-1035, Rīga,
Tālr.: + 371 714 9640, 7 149 641
Fakss: + 371 914 9646

Lithuania

GRUNDFOS Pumps UAB
Smolensko g. 6
LT-03201 Vilnius
Tel: + 370 52 395 430
Fax: + 370 52 395 431

Malaysia

GRUNDFOS Pumps Sdn. Bhd.
7 Jalan Peguam U1/25
Glenmarie Industrial Park
40150 Shah Alam
Selangor
Phone: +60-3-5569 2922
Telefax: +60-3-5569 2866

Mexico

Bombas GRUNDFOS de México S.A. de
C.V.
Boulevard TLC No. 15
Parque Industrial Stiva Aeropuerto
Apodaca, N.L. 66600
Phone: +52-81-8144 4000
Telefax: +52-81-8144 4010

Netherlands

GRUNDFOS Netherlands
Veluwezoom 35
1326 AE Almere
Postbus 22015
1302 CA ALMERE
Tel.: +31-88-478 6336
Telefax: +31-88-478 6332
E-mail: info_gnl@grundfos.com

New Zealand

GRUNDFOS Pumps NZ Ltd.
17 Beatrice Tinsley Crescent
North Harbour Industrial Estate
Albany, Auckland
Phone: +64-9-415 3240
Telefax: +64-9-415 3250

Norway

GRUNDFOS Pumper A/S
Strømsveien 344
Postboks 235, Leirdal
N-1011 Oslo
Tlf.: +47-22 90 47 00
Telefax: +47-22 32 21 50

Poland

GRUNDFOS Pompy Sp. z o.o.
ul. Klonowa 23
Baranowo k. Poznania
PL-62-081 Przeźmierowo
Tel: (+48-61) 650 13 00
Fax: (+48-61) 650 13 50

Portugal

Bombas GRUNDFOS Portugal, S.A.
Rua Calvet de Magalhães, 241
Apartado 1079
P-2770-153 Paço de Arcos
Tel.: +351-21-440 76 00
Telefax: +351-21-440 76 90

Romania

GRUNDFOS Pompe România SRL
Bd. Biruintei, nr 103
Pantelimon county Ilfov
Phone: +40 21 200 4100
Telefax: +40 21 200 4101
E-mail: romania@grundfos.ro

Russia

ООО ГРУНДФОС
Россия, 109544 Москва, ул. Школьная
39
Тел. (+7) 495 737 30 00, 564 88 00
Факс (+7) 495 737 75 36, 564 88 11
E-mail grundfos.moscow@grundfos.com

Serbia

GRUNDFOS Predstavništvo Beograd
Dr. Milutina Ivkovića 2a/29
YU-11000 Beograd
Phone: +381 11 26 47 877 / 11 26 47 496
Telefax: +381 11 26 48 340

Singapore

GRUNDFOS (Singapore) Pte. Ltd.
24 Tuas West Road
Jurong Town
Singapore 638381
Phone: +65-6865 1222
Telefax: +65-6861 8402

Slovenia

GRUNDFOS d.o.o.
Šlandrova 8b, SI-1231 Ljubljana-Črnuče
Phone: +386 1 568 0610
Telefax: +386 1 568 0619
E-mail: slovenia@grundfos.si

South Africa

Grundfos (PTY) Ltd.
Corner Mountjoy and George Allen Roads
Wilbart Ext. 2
Bedfordview 2008
Phone: (+27) 11 579 4800
Fax: (+27) 11 455 6066
E-mail: lsmart@grundfos.com

Spain

Bombas GRUNDFOS España S.A.
Camino de la Fuentevilla, s/n
E-28110 Algete (Madrid)
Tel.: +34-91-848 8800
Telefax: +34-91-628 0465

Sweden

GRUNDFOS AB
(Box 333) Lunnagårdsgatan 6
431 24 Mölndal
Tel.: +46 31 332 23 000
Telefax: +46 31-331 94 60

Switzerland

GRUNDFOS ALLDOS International AG
Schönmattpstraße 4
CH-4153 Reinach
Tel.: +41-61-717 5555
Telefax: +41-61-717 5500
E-mail: grundfosalldos-CH@grundfos.com

Switzerland

GRUNDFOS Pumpen AG
Bruggacherstrasse 10
CH-8117 Fällanden/ZH
Tel.: +41-1-806 8111
Telefax: +41-1-806 8115

Taiwan

GRUNDFOS Pumps (Taiwan) Ltd.
7 Floor, 219 Min-Chuan Road
Taichung, Taiwan, R.O.C.
Phone: +886-4-2305 0868
Telefax: +886-4-2305 0878

Thailand

GRUNDFOS (Thailand) Ltd.
92 Chaloeam Phrakiat Rama 9 Road,
Dokmai, Pravej, Bangkok 10250
Phone: +66-2-725 8999
Telefax: +66-2-725 8998

Turkey

GRUNDFOS POMPA San. ve Tic. Ltd. Sti.
Gebze Organize Sanayi Bölgesi
İhsan dede Caddesi,
2. yol 200. Sokak No. 204
41490 Gebze/ Kocaeli
Phone: +90 - 262-679 7979
Telefax: +90 - 262-679 7905
E-mail: satis@grundfos.com

Ukraine

ТОВ ГРУНДФОС УКРАЇНА
01010 Київ, Вул. Московська 86,
Тел.: (+38 044) 390 40 50
Факс.: (+38 044) 390 40 59
E-mail: ukraine@grundfos.com

United Arab Emirates

GRUNDFOS Gulf Distribution
P.O. Box 16768
Jebel Ali Free Zone
Dubai
Phone: +971-4- 8815 166
Telefax: +971-4-8815 136

United Kingdom

GRUNDFOS Pumps Ltd.
Grovebury Road
Leighton Buzzard/Beds. LU7 8TL
Phone: +44-1525-850000
Telefax: +44-1525-850011

U.S.A.

GRUNDFOS Pumps Corporation
17100 West 118th Terrace
Olathe, Kansas 66061
Phone: +1-913-227-3400
Telefax: +1-913-227-3500

Uzbekistan

Представительство ГРУНДФОС в
Ташкенте
700000 Ташкент ул.Усмана Носира 1-й
тулик 5
Телефон: (3712) 55-68-15
Факс: (3712) 53-36-35

Addresses revised 27.04.2012

98131771 0712

ECM: 1085307

The name Grundfos, the Grundfos logo, and the payoff Be-Think-Innovate are registered trademarks owned by Grundfos Management A/S or Grundfos A/S, Denmark. All rights reserved worldwide.